

ES-TYP4P-FPS(H)-P(x), TYP4P, FPS HW ELECTRICAL SCHEMATIC FOR PLUS UNITS WITH DRYER (3)

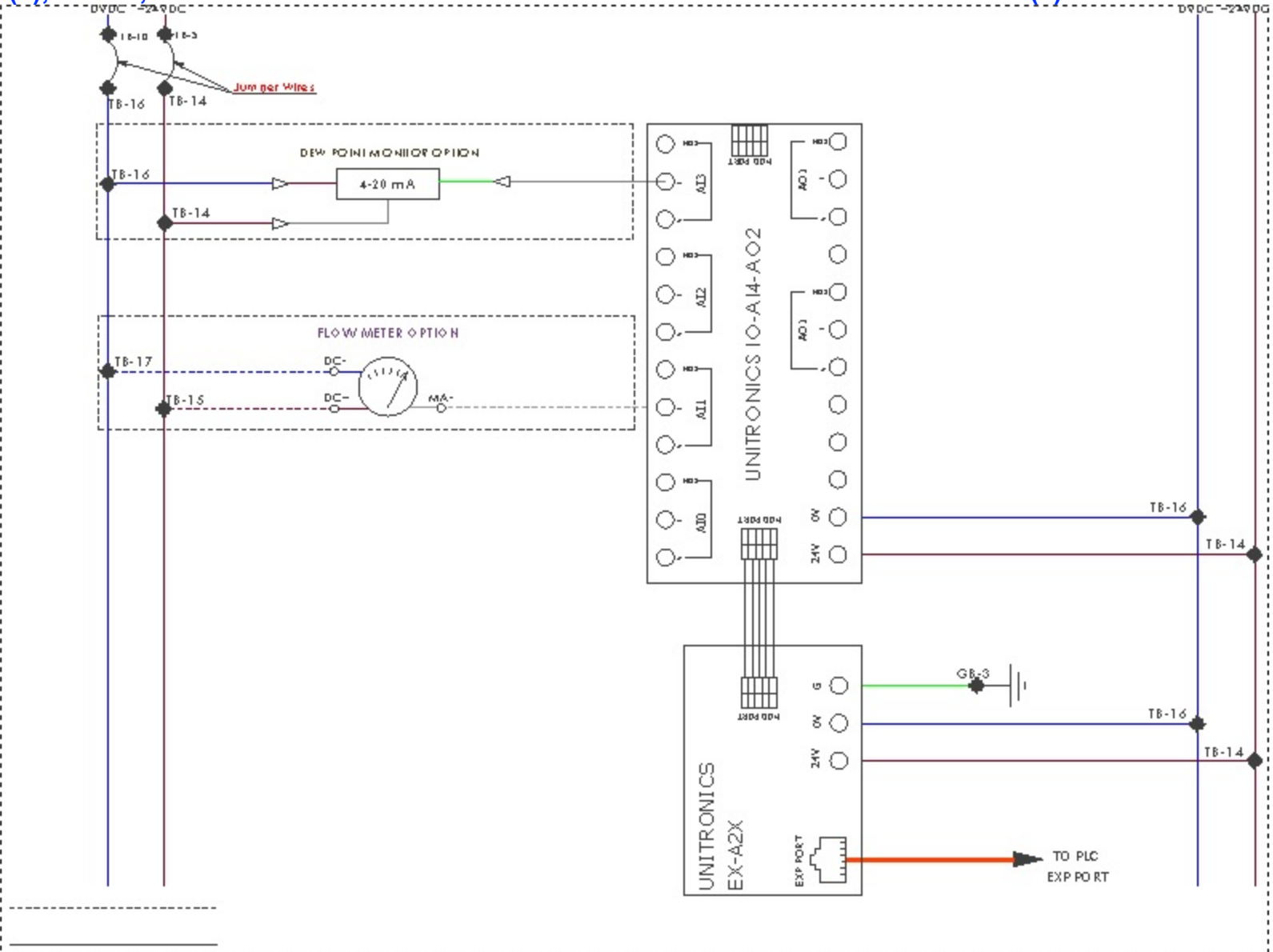

CUSTOMER CONNECTIONS
FACORY CONNECTIONS

ES-TYP4P-FPS(H)-P(x), TYP4P, FPS HW ELECTRICAL SCHEMATIC FOR PLUS UNITS WITH DRYER (4)

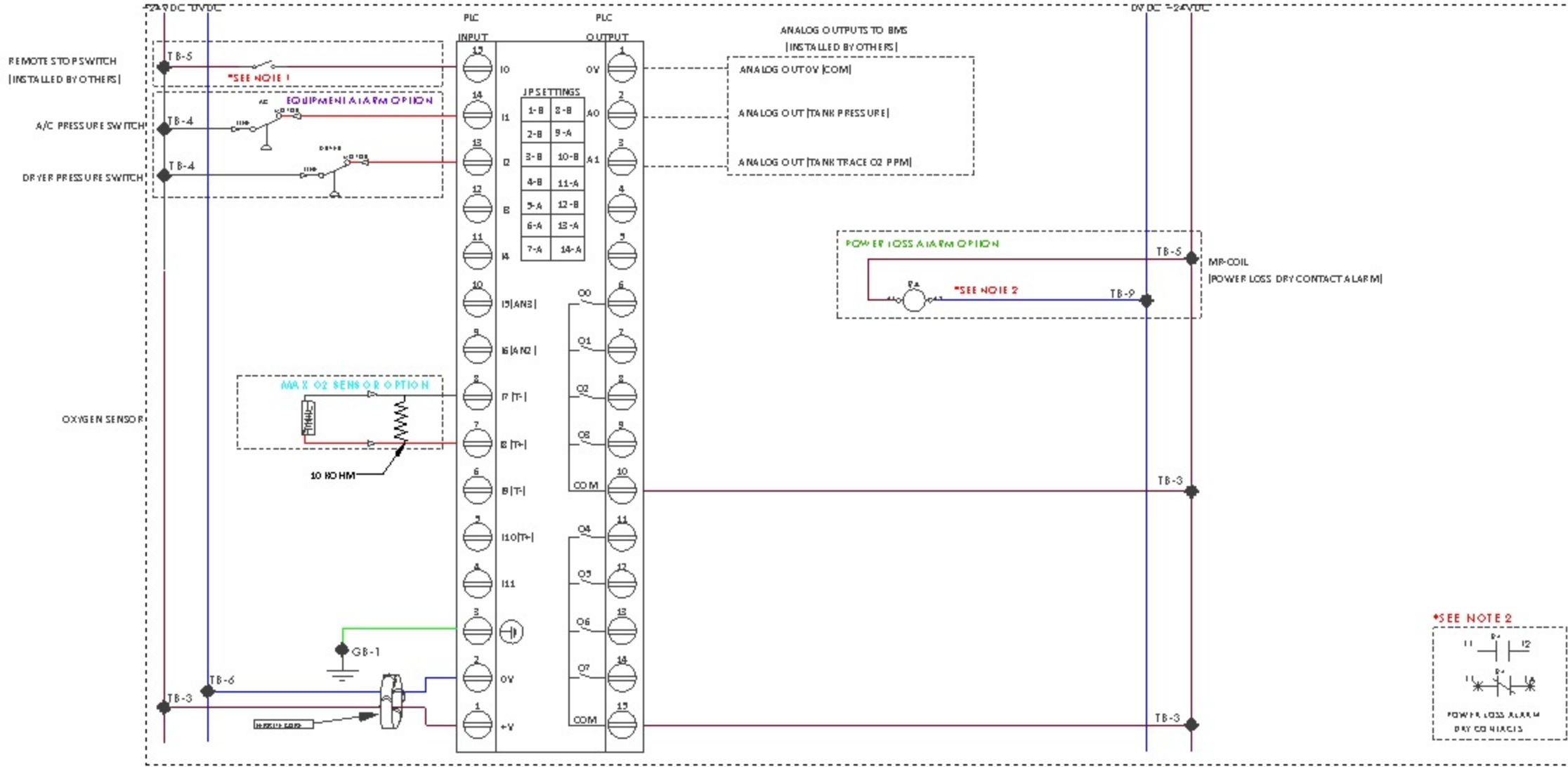

GENERAL NOTES:
 [1] SEE MANUAL FOR FURTHER INFORMATION
 [2] IF ALARM IS ACTIVE 11-12 WILL BE OPEN AND 13-14 WILL BE CLOSED

ES-TYP4P-FPS(H)-P(x), TYP4P, FPS HW ELECTRICAL SCHEMATIC FOR PLUS UNITS WITH DRYER

CUSTOMER
POWER
CONNECTION

L1
L2
G

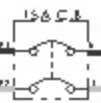

TB-12
TB-13
GB-1

TB-12

TB-13

TB-12

TB-13
GB-2

TERMINAL BLOCK SCHEDULE

TERMINAL BLOCK	FUNCTION
1	PLC/O7
2	PLC/O0
3-5 JUMPED	+24VDC
6-11 JUMPED	OVDC
12	110-220VAC (L1)
13	110-220VAC (L2)
16-17 JUMPER	OVDC
14-15 JUMPED	+24VDC

TORQUE SPECIFICATIONS

ITEM	MIN-MAX
PLC	0.5 Nm MAX
POWER SUPPLY	0.67 Nm MAX

GENERAL NOTE:

PRODUCTS SUPPLY VOLTAGE IS FACTORY CONFIGURE DA AND MAY NOT BE CHANGED POST BUILD.
STANDARD ELECTRICAL IS 110V. ALTERNATE VOLTAGE IS AVAILABLE IN -220 AND -CEP PRODUCTS. SEE
PRODUCT INFORMATION LABEL FOR CONFIRMATION OF SPECIFICATIONS.

WIRING TABLE

AWG	COLOR	SERVICE	FIELD/TERMINAL
14	BLACK	110/220V (L1)	FIELD - INTERNAL
14	WHITE	110/220V (L2)	FIELD - INTERNAL
16-18	BROWN	+24VDC	INTERNAL
16-18	BLUE	OV	INTERNAL
16-22	GRAY/RED	SIGNAL	INTERNAL
16-22	ANY	SIGNAL	FIELD



TB-3

TB-6

+24VDC

OVDC

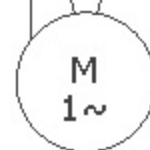

DRYER OPTION

TYP4P-07H-Ai-FPS, TYP4P, HWU ELECTRICAL ASSEMBLY, IC, FPS (2)

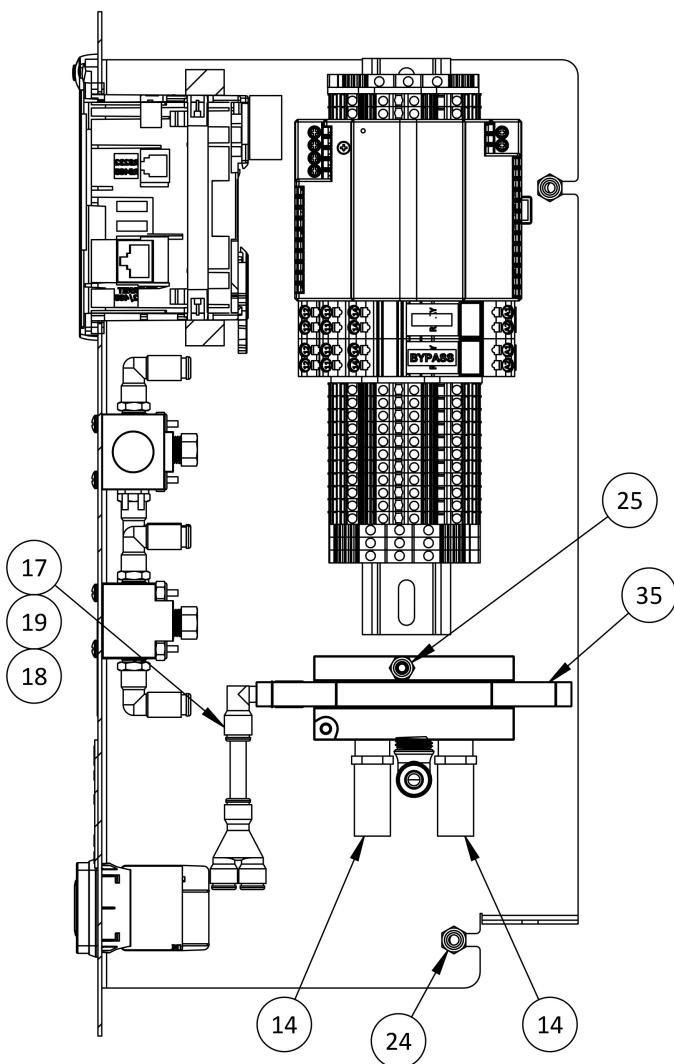
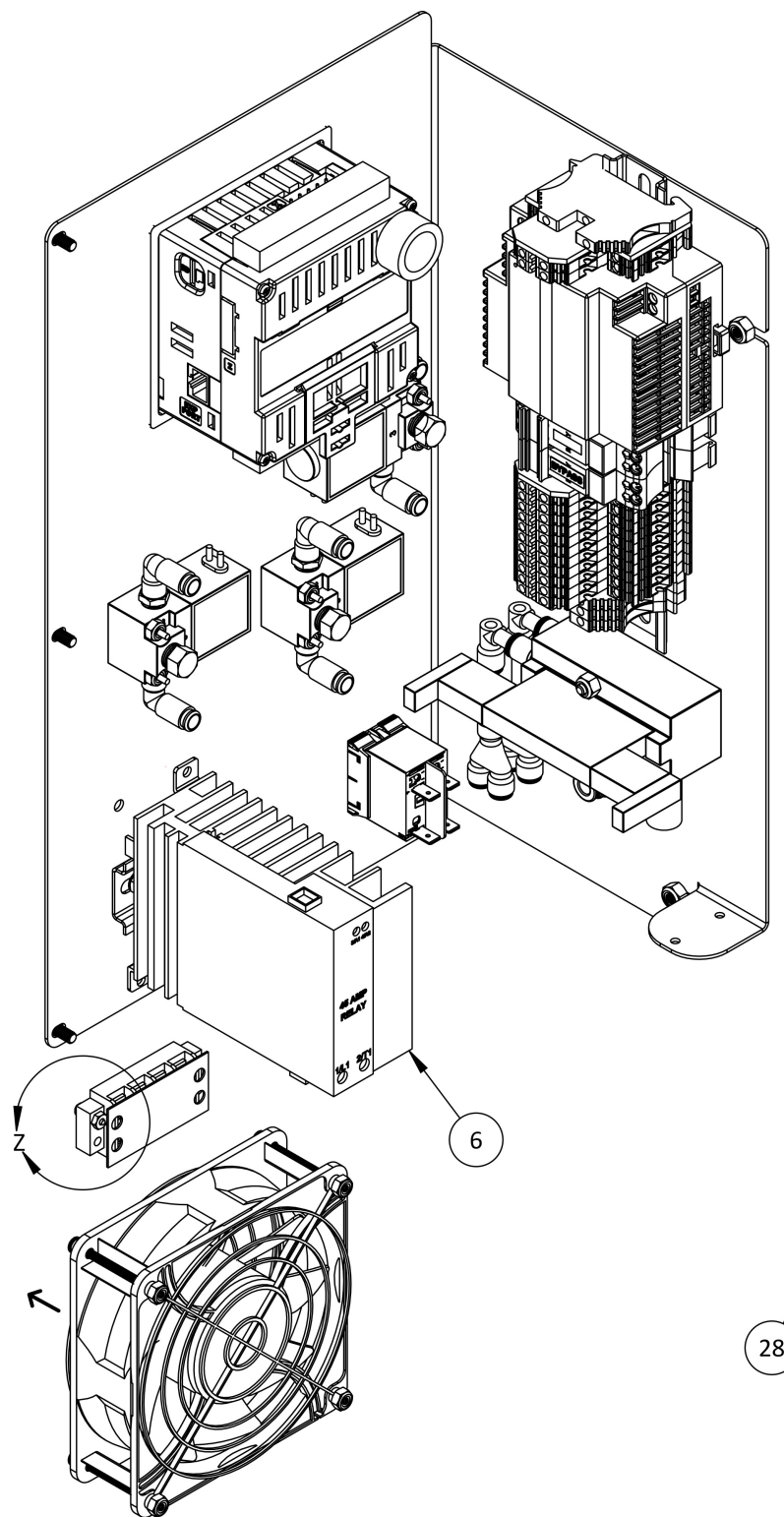
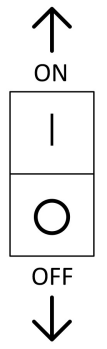

SECTION B-B

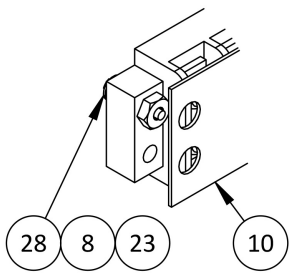

DETAIL Z
SCALE 2 : 3

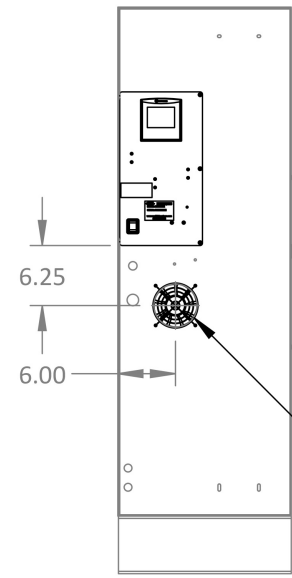

SCALE 1 : 20

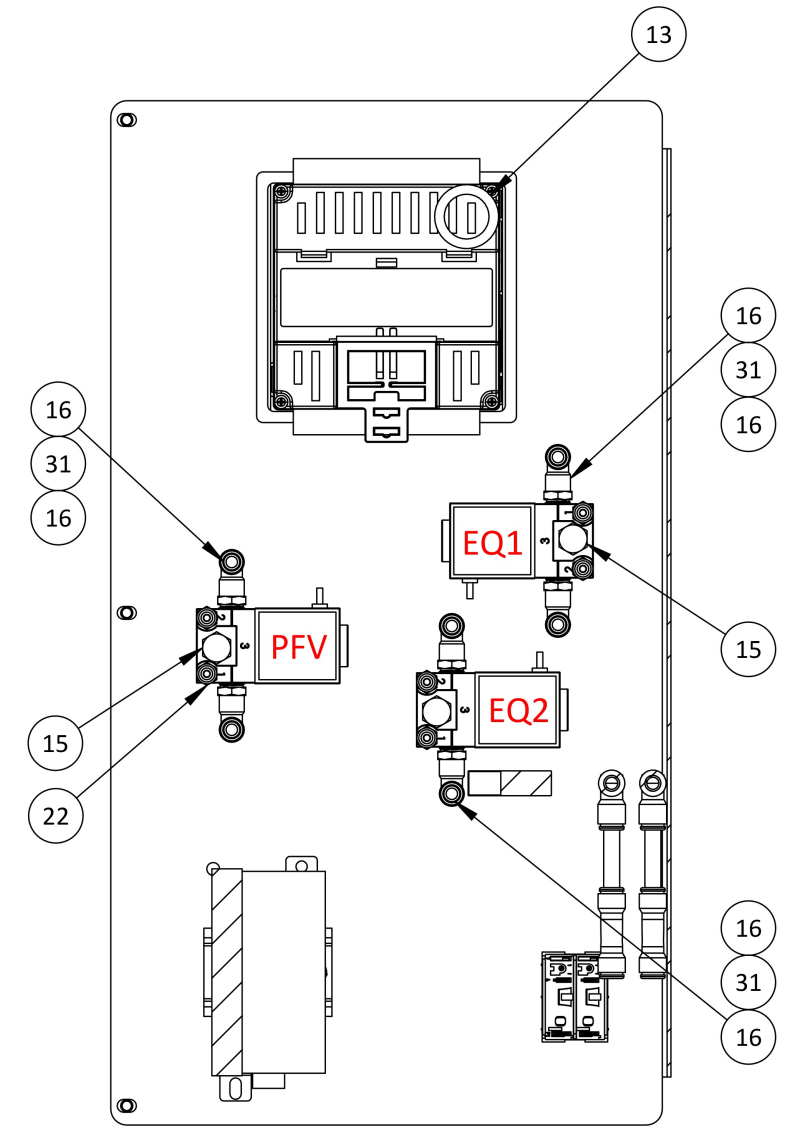

SECTION A-A

PUNCH 4-1/2" OD
HOLE FOR FAN

